



# JAYO

PETROLEUM MACHINERY CO., LTD

**European  
Standard**

**Reasonable  
Price**

**First-rate  
Service**



**ATRIS GROUP**



## ■ ■ ■ ■ BRIEF INTRODUCTION

---

"ATRIS Group", a joint-venture company, is one of leading professional designers, manufacturers and exporters of petroleum equipment and accessories in China. JAYO Petroleum Machinery Co., Ltd is her sister company.

Our products cover: fuel dispenser; LPG dispenser; nozzle; swivel; coupling; pump; valve; flow meter; hose; quick coupling; filter; measuring can; corrugated pipe; high pressure washer; machinery seal; tank lorry and its spare parts; equipment of gas station and oil depot.

In order to supply our customers with the best products, we adopt world advanced technology, European style and European standard.

We have obtained the ISO9001 Quality System Verification 2000 and other countries' related certifications. At the same time, we have established a world marketing network covering Eastern Europe, Africa, Southeast Asia, Western Asia, Middle east, South America and etc.

Abiding by the principle of " competitive price, superior quality, excellent service", we have had a large share of world market and our products with "A3C" logo enjoy good reputation among our customers. We will keep dedicating to the improvement of product quality and R&D of new products to satisfy market need.



## ◆Fuel Dispenser

Jayo provides 30,40,50,60 model fuel dispensers with luxury series and economy series which can meet all client's demand.



30B111



30B222E



30B222



50B631



60B111



60B222

## ◆Optional Components

- ◇ Gear Pump or Vane Pump
- ◇ 220V Ex-Motor or 380V Ex-Motor
- ◇ Stainless Steel Side Panel or Carbon Steel Side Panel
- ◇ Suction Type or Submersible Type ('B' Stand for Suction Pump Type, 'C' Stand for Submersible Pump Type)

Add: No.36, Mid Dongfeng Road, Jinshui District, Zhengzhou, Henan Province, China

Zip Code: 450053    Telefax: +86 371 63295101, 63295102

E-mail: xmd@jayopetro.com    xmd371@yahoo.com.cn

Http://www.jayopetro.com



### ◆ Technical Data. 1 (for 30.40.50Series)

- ◇ Accuracy:  $\pm 0.25\%$
- ◇ Delivery Rate: 5 ~ 50L/min
- ◇ Measurable Minimum: 5L
- ◇ Noise:  $\leq 80\text{dB(A)}$
- ◇ Inlet Vacuum:  $\geq 0.06\text{MPa}$
- ◇ Display: LCD Display
- ◇ Register Range: 0.00 ~ 9800.00L or Yuan
- ◇ Totalizer Range: 0.00 ~ 99999999999.99L or Yuan
- ◇ Range of Price: 0.01 ~ 99.99Yuan/L
- ◇ Preset Min Value: 0.00 ~ 0.99L
- ◇ Power Supply: AC380 V  $\pm 20\%$  or AC220V  $\pm 20\%$
- ◇ Frequency: 50HZ  $\pm 1\text{HZ}$
- ◇ Rating Power: 0.75KW
- ◇ Ambient Humidity: 30% ~ 90%
- ◇ Ambient Temperature:  $-45\text{ }^{\circ}\text{C} \sim +60\text{ }^{\circ}\text{C}$
- ◇ Anti-Explosive ID: Exdm[ib]ib II At3

### ◆ Specifications

Model	Nozzle	Product	Display Each Side	Flow Range/Min
30B111	1	1	1	5-50L/Min
30C111	1	1	1	5-50L/Min
30B212	2	1	2	5-50L/Min
30C212	2	1	2	5-50L/Min
30B222	2	2	2	5-50L/Min
30C222	2	2	2	5-50L/Min
40B421	4	2	1	5-50L/Min
40C421	4	2	1	5-50L/Min
40B631	6	3	1	5-50L/Min
40C631	6	3	1	5-50L/Min
50B421	4	2	1	5-50L/Min
50C421	4	2	1	5-50L/Min
50B631	6	3	1	5-50L/Min
50C631	6	3	1	5-50L/Min
50B841	8	4	1	5-50L/Min
50C841	8	4	1	5-50L/Min
60B111(90L)	1	1	1	5-90L/Min
60B111(120L)	1	1	1	5-120L/Min
60B111(160L)	1	1	1	5-160L/Min
60B222(90L)	2	2	2	5-90L/Min

Add: No.36, Mid Dongfeng Road, Jinshui District, Zhengzhou, Henan Province, China

Zip Code: 450053   Telefax: +86 371 63295101 ,63295102

E-mail: xmd@jayopetro.com   xmd371@yahoo.com.cn

Http://www.jayopetro.com



## ◆AUTOMATIC NOZZLES



JY2101-11A



JY2101-11B



JY13A



JY2101-11AP



JY2101-11BP



JY13AP

## ◆Ordering Specifications:

Product	Inlet Size	Outlet Diameter	Flow Rate
JY 2101-11A	BSPT / NPT 3/4"	15/16"	0-60L/M
JY2101-11AP	BSPT / NPT 3/4"	13/16"	0-45L/M
JY 2101-11B	BSPT / NPT 3/4"	15/16"	0-60L/M
JY2101-11BP	BSPT / NPT 3/4"	13/16"	0-45L/M
JY 13A	BSPT / NPT 3/4"/1"	15/16"	0-70L/M
JY 13AP		13/16"	0-50L/M

## ◆High-flow Nozzle & Measuring Nozzle



JY120L  
(Automatic Nozzle)

Inlet:NPT / BSPT 1"  
Outlet: 1"1<sup>3</sup>/<sub>16</sub>"  
Flow: 0-90 / 120 L/M  
Pressure: 0.18Mpa



JY1250  
(Manual Nozzle)

Inlet:NPT / BSPT1<sup>1</sup>/<sub>2</sub>"  
Outlet: 1<sup>5</sup>/<sub>8</sub>"  
Flow rate: 0-250L/M  
Pressure: 0.18Mpa



JY1295  
(Manual Nozzle)  
Inlet:PF1<sup>1</sup>/<sub>2</sub>"2"-11gear,  
PF2<sup>1</sup>/<sub>2</sub>"-8gear,  
Outlet: 1<sup>1</sup>/<sub>2</sub>"  
Flow rate: 0-290L/M  
Pressure: 0.18Mpa



JY-LLY  
(Measuring Nozzle)  
Diameter(mm):25&32  
Min flow(L/M):25&32  
Rated flow(L/M):35&65  
Max flow(L/M):60&120  
Precision:less than1%

Add: No.36, Mid Dongfeng Road, Jinshui District, Zhengzhou, Henan Province, China

Zip Code: 450053    Telefax: +86 371 63295101 ,63295102

E-mail: xmd@jayopetro.com    xmd371@yahoo.com.cn

Http://www.jayopetro.com



## ◆ Spare Parts of Automatic Nozzle

### ◆ Spout



For JY2101-11A/11AP/11B/11BP



For JY13A/13AP Nozzle

### ◆ Plastic Insulator



For JY11A/11AP



For JY11B/11BP



For JY120L



For JY13A/13AP

### ◆ Lever and Lever-Guard Assembly



For JY11A/11B/120L Series



For JY13A/13AP



For JY11A/11B Series

### ◆ Nozzle Assemblies



For JY11A/11AP/120L Series



For JY11B/11BP



For JY13A/13AP

Add: No.36, Mid Dongfeng Road, Jinshui District, Zhengzhou, Henan Province, China

Zip Code: 450053    Telefax: +86 371 63295101 , 63295102

E-mail: xmd@jayopetro.com    xmd371@yahoo.com.cn

Http://www.jayopetro.com



## ◆ Swivels and Couplings



241TPS Hose Swivel

241TPS hose swivel is designed for applications where easy handling of nozzle and hose important for customer's convenience. It is installed between the nozzle and the hose to reduce strain, provides flexibility and reduces premature hose wear.

Specification: 3/4" F × 3/4" M (NPT / BSPT)



45 Series Hose Swivel

It is installed between the nozzle and the hose to reduce strain, provides flexibility so that the fueling hose lasts long.

Specification: 3/4" & 1" NPT/BSPT



JGHB



JGH

JGHB and JGH hose swivel are designed for use between the hose and fuel oil nozzle, or between the hose and other equipment. Providing 360° rotation action.

Specification: 3/4" & 1" NPT/BSPT

JGDB and JGD hose coupling are designed for use between the hose and pipe, or between hose and other equipment.

Specification: 3/4" & 1" NPT/BSPT



JGDB



JGD



36S8 Swivel Specification: 3/4" & 1" NPT/BSPT(Female) × M34 × 1.5(Male)

It can change the connection between different threads and different calibers, which is convenient to use. The full-circle swivel reduces the physical strain of aligning the nozzle with the fill pipe. Screen protects the nozzle from debris.

It is designed for use with nozzle. The full-circle swivel reduces the physical strain of aligning the nozzle with the fill pipe. Different threads and different calibers can be replaced freely.



36S7 Swivel

Specification: 3/4" & 1" NPT/BSPT(Male) × 3/4" & 1" NPT/BSPT(Female)

Add: No.36, Mid Dongfeng Road, Jinshui District, Zhengzhou, Henan Province, China

Zip Code: 450053    Telefax: +86 371 63295101 , 63295102

E-mail: xmd@jayopetro.com    xmd371@yahoo.com.cn

Http://www.jayopetro.com



## ◆ Breakaway Valve



BC-CH Valve

It is a dry reconnected breakaway for the conventional dispensing market. It is designed to be installed on fuel dispensing hoses, and will separate when subjected to a designated pull force. The dual valve seat automatically stops the flow of fuel and limits any fuel spillage while protecting dispensing equipment. While reconnecting the separated halves, its seals tightly on an O- ring before the poppet stems engage to open the valve. For the proper operation on high-hanging hoses, it must always be installed with a straightening hose with a minimum length of 9". For low hose applications, it should be installed down stream of the retractor cable.

Specification: BC-CH NPT / BSPT 3/4" (Flow: 0-60L/M)



BC-YC Valve

It is designed to be installed on fuel dispensing hoses, and will separate when subjected to a designed pull force. The dual valve seat automatically, stopping the flow of fuel and limiting any fuel spillage, while protecting the dispensing equipment. For proper operation, BC-YC3/4" should be installed with a "straightening" hose with a minimum length of 9". BC-YC1" should be installed with a minimum length of 12".

Specification: NPT / BSPT3/4"xNPT / BSPT3/4" ( Flow: 0-60L/M)  
NPT / BSPT 1" xNPT / BSPT 1" ( Flow: 0-120L/M)



JY-TL Valve

This is one designed valves which for preventing accidents forceful on pipeline. It is connected between the dispenser and fuel nozzle, a tailor-made double-valve in a forceful correction which automatically cuts off the flow and prevents fuel spillage, therefore protect the dispenser and station. This is one necessary and ideal safety equipment.

Specification: NPT / BSPT 3/4" (Flow: 0-60L/M)  
NPT / BSPT 1" (Flow: 0-120L/M)

## ◆ Oil Viewing Device



Inlet thread: NPT1"&BSPT1",  
NPT3/4"&BSPT3/4" M33X1.5  
Flux range: 0-60L/M  
Nominal pressure: 0.18Mpa



Inlet thread: NPT& BSPT1", NPT&BSPT3/4"  
3/4": 480× 250× 350mm  
1": 470× 250× 410mm  
Nominal pressure: 0.18Mpa

Add: No.36, Mid Dongfeng Road, Jinshui District, Zhengzhou, Henan Province, China

Zip Code: 450053    Telefax: +86 371 63295101, 63295102

E-mail: xmd@jayopetro.com    xmd371@yahoo.com.cn

Http://www.jayopetro.com





## ◆ Solenoid Valve



## ◆ Ordering Specification:

Specification	D-3/4"	D-1"
Connection	Flange / Thread	Flange / Thread
Flow Rate	50L/M	85L /M
Work Pressure	0.035~0.45 Mpa	0.035~0.45 Mpa
Voltage	AC220V / 50Hz DC24V / 12V	AC220V / 50Hz DC24V / 12V
Ambient Temperature	-40°C ~55°C	-40°C ~55°C
Product Temperature	-40°C ~65°C	-40°C ~65°C

## ◆ Dual-Gate Bottom Valve



Name	Specification	Material	Working Pressure	Instruction
Dual-Gate Bottom Valve	Dg25	Brass Alloy	1MPa	Suitable for non-return of various liquid
	Dg40			
	Dg50			
	Dg80			
	Dg100			

## ◆ Angle Check Valve



DJF Valve  
JY-DJF

It is installed on suction system, fuel lines on top of fuel storage tank to maintain prime. Models are available with male thread inlet for connection directly into tank bung fittings or with female inlets for connection to a nipple that is threaded into a tank bung fitting. Single-popper models can be used in applications where the valve is easily accessible for maintenance and disc cleaning or replacement.

Specification: 1 1/2" ( Height: 116mm)  
2" (Height: 123mm)



## ◆ Pumps & Flowmeters for Fuel Dispenser

### ◆ Pump

The pumps are suitable for gasoline, kerosene, diesel and some compatible fuel.  
Body: Aluminum alloy ; Construction: Stainless steel cylinder bushing.

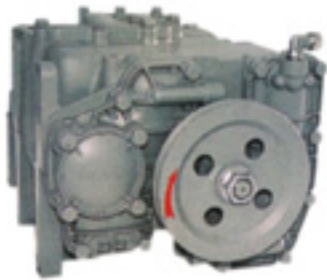

JY-90 Pump



JY-75 Pump



JY-TL90 Pump



JY-50 Pump

Specification	JY-90	JY-75	JY-TL90	JY-50
Flow Rate	45L/M-90L/M	45L/M-65L/M	45L/M-70L/M	45L/M-55L/M
Rotation Speed	680Rpm-980Rpm	630Rpm	630Rpm	900Rpm
Vacuum Pressure	≥0.06Mpa	≥0.054Mpa	≥0.054Mpa	≥0.06Mpa
Noise	≤72Db	≤68Db	≤70Db	≤72Db
Working Pressure	0.18-0.3Mpa	0.12-0.25Mpa	0.16-0.25Mpa	0.18-0.24Mpa

### ◆ Flowmeter

Novel appearance, small body, excellent abrasion-resistance, accurate measurement, long life and reliable service.

Body: Aluminum alloy ; Construction: Stainless steel cylinder bushing.



JY-100 Meter



JY-473 Meter



JY-65 Meter



JY-85 Meter



JY-05 Meter

Specification	JY-100	JY-473	JY-65	JY-85	JY-05
Delivery capacity per revolution	0.5L	0.5L	0.5L	0.5L	0.5L
Minimum adjusting quantity	0.05%	0.04%	0.025%	0.05%	0.05%
Accuracy with flow range	±0.2%	±0.2%	±0.2%	±0.3%	±0.2%
Flow range	5-90L	3-100L	5-90L	5-90L	3-100L
Repeatable variation	≤±0.1%	≤±0.1%	≤±0.1%	≤±0.1%	≤±0.1%

Add: No.36, Mid Dongfeng Road, Jinshui District, Zhengzhou, Henan Province, China

Zip Code: 450053    Telefax: +86 371 63295101 , 63295102

E-mail: xmd@jayopetro.com    xmd371@yahoo.com.cn

Http://www.jayopetro.com



## ◆ LLY Flowmeter and LC Flowmeter

The LLY root flowmeter and LC gear flowmeter are widely used in flow measurement in the industrial field such as petroleum exploitation, oil refinery, chemical and oil storage.

### ◆ Picture



LC-gear flowmeter



LLY-root flowmeter



LC-gear flowmeter(s.s306)

### ◆ Technical data

Model	Dia (mm)	Flow range
LLY	15	0.25-2.5
LLY	20	0.25-2.5
LLY	25	0.6-6
LLY	40	1.6-16
LLY	50	2.5-25
LLY	80	6-60
LLY	100	10-100
LLY	150	25-250

Model	Dia (mm)	Flow range
LC	15	0.15-1.5
LC	20	0.3-3
LC	25	0.6-6
LC	40	1.5-15
LC	50	2.4-24
LC	80	6-60
LC	100	10-100
LC	150	19-190

- ◇ Working Pressure (MPa) :0.6, 1.0, 1.6, 2.5, 4.0
- ◇ Working Temperature(°C) :-45°C -+60°C
- ◇ Medium Viscosity (mPa.s) :0.6-150
- ◇ Accuracy:0.2%, 0.5%
- ◇ Flow Range(m<sup>3</sup>/h)
- ◇ Material of Flowmeter: cast iron, cast steel, stainless steel.
- ◇ Type: 1.totalizer 2. reset zero 3. totalizer and sensor 4.reset zero and sensor

### ◆ Features&Benefits:

It possesses many advantages such as large testing range,high precision, steady performance, testing high temperature and viscosity fluid, easy installation ,convenient operation and so on.

Add: No.36, Mid Dongfeng Road, Jinshui District, Zhengzhou, Henan Province, China  
 Zip Code: 450053    Telefax: +86 371 63295101 ,63295102  
 E-mail: xmd@jayopetro.com    xmd371@yahoo.com.cn  
[Http://www.jayopetro.com](http://www.jayopetro.com)



## ◆ JY Series unloading oil measure equipments from the tank



ZZ type

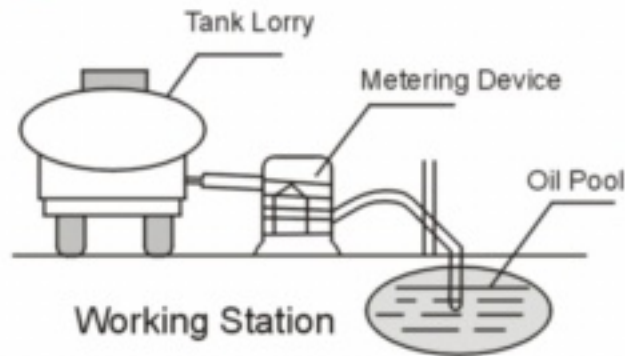

YC type

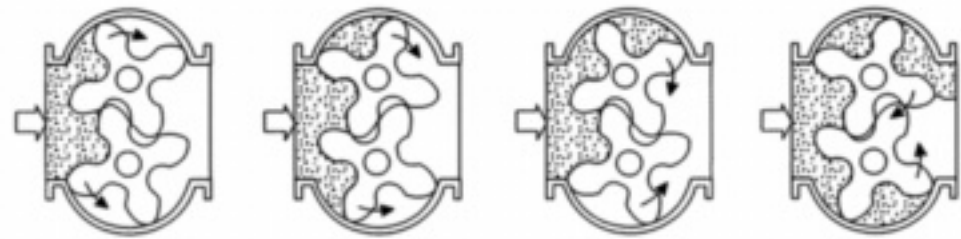

Construction

## ◆ Technical Specification

Accuracy	0.2%. 0.5%
Nominal Pressure	PN1.0-2.5Mpa
Nominal Diameter	DN40mm.50mm.80mm.100mm
Medium	Diesel, kerosene, gasoline and so on.
Working Temperature	-45°C -+60°C
Working State	Using pump to add pressure, 10 tons oil will be finished in 40 minutes.

## ◆ Components

- ◇ Flow meter (all kinds of flow meter, with reset zero, sensor, totalizer according to your request.)
- ◇ Air-removed filter (separate and eliminate gas in the gasoline, kerosene, diesel and other mixed liquid to improve the accuracy.)
- ◇ According to the customers' need, we can match the pump and motor.
- ◇ Fixed equipments.( metal holder or fixed on a go-cart)

## ◆ Features & Benefits

- ◇ High-accuracy and low-noise.
- ◇ Simple frame and convenience-use
- ◇ Display counter with reset zero and sensor.
- ◇ Fixed style or moving style.
- ◇ Many components have compatibility, in size, flanges and so on.

Add: No.36, Mid Dongfeng Road, Jinshui District, Zhengzhou, Henan Province, China

Zip Code: 450053    Telefax: +86 371 63295101 ,63295102

E-mail: xmd@jayopetro.com    xmd371@yahoo.com.cn

[Http://www.jayopetro.com](http://www.jayopetro.com)



## ◆ J Series Positive Displacement Flow Meter



### ◆ Features & Benefits

- ◇ Excellent stepless adjusting mechanism allows a micro adjustment of the meter.
- ◇ High accuracy and repeatability over the widest range of flow; Superior accuracy at constant flow .
- ◇ Low maintenance, no metal-to-metal contact in measuring chamber, long life service.
- ◇ Low pressure loss, a true gravity flow meter.
- ◇ Accuracy regardless of pressure fluctuations, temperature variation, viscosity.
- ◇ Choice of aluminum ,cast iron and stainless steel materials of construction.

### ◆ Technical Data

Model	Flow Rate	Diameter	Accuracy	Volume Per Revolution
J-40-1	25-250L/min	40mm/ 1 1/2"	±0.2%	0.309L
J-50-1	50-500L/min	50mm/ 2"	±0.2%	0.681L
J-80-1	100-1000L/min	80mm/ 3"	±0.2%	1.839L

### ◆ Application Range

- ◇ Refined petroleum products.
- ◇ Aviation gasoline and jet fuel.
- ◇ A wide variety of products such as :liquid sugar , corn syrup ,dextrose ,fructose ,sucrose , maltose , lactose , corn oil , soy bean oil , cotton seed oil , coconut oil.
- ◇ Treated water (deionized, demineralized and potable water).
- ◇ Chlorinated solvents and general solvent metering
- ◇ Acid Ph liquids
- ◇ Liquefied petroleum gas(LPG).
- ◇ Crude oil , also for heated and /or viscous liquids.
- ◇ Oil or water based latex products, polyester resins and adhesive (neutral pH), also for metering herbicides and nitrogen fertilizer solutions.
- ◇ Herbicide
- ◇ Sodium hydroxide(caustic)solutions, high sulfur crude oil and other alkaline ph liquids.
- ◇ Abrasive liquids

Add: No.36, Mid Dongfeng Road, Jinshui District, Zhengzhou, Henan Province, China

Zip Code: 450053    Telefax: +86 371 63295101 ,63295102

E-mail: xmd@jayopetro.com    xmd371@yahoo.com.cn

Http://www.jayopetro.com



## ◆ SM Series Positive Displacement Vane Meter



### ◆ Features & Benefits

- ◇ Stepless adjusting mechanism allows a micro adjustment of the meter.
- ◇ Special designed manifold in line separates from measuring chamber to avoid stress coming from the installation. Low head loss.
- ◇ Simple constructions: Rotor-blades for easy and low maintenance cost.
- ◇ Wearing compensation :To maintain a good accuracy all along the years.
- ◇ Meter also for viscous products: up to 800 Cst.

### ◆ Technical Data

Model	SM-50	SM-80
Size	50mm/2"	80mm/3"
Volume Per Revolution	0.4L/0.08 US Gallons	2.27L/0.5 US Gallons
Max. Flow Rate	24 m <sup>3</sup> /H 400L/min 105US Gallon	80 m <sup>3</sup> /H 1333L/min 360US Gallon
Min. Flow Rate	2.4 m <sup>3</sup> /H 40L/min 10.5US Gallon	8 m <sup>3</sup> /H 133.3L/min 36US Gallon
Accuracy	±0.2%	
Repeatability	≤0.05%	
Max. Operation Pressure	8Bar/120PSI 8.3kg/cm <sup>3</sup>	10Bar/150PSI 10.5kg/cm <sup>3</sup>
Working Temperature Range	-45°C -+60°C	
Max. Viscosity	800cps/3850 SSU	
Weight Net	20kg/44Lbs	56kg/123Lbs
Width	287mm	356mm
Depth	235mm	370mm
Height	406mm	405mm

### ◆ Application Range

- ◇ Oil company: refineries, oil depots, gas station and tank trucks distribution.
- ◇ Airports: aircraft refuellers.
- ◇ Army : depot reception or loading trucks.
- ◇ Administration : railway companies , public transport
- ◇ Ports: boats/ barges
- ◇ Private oil transport companies

Add: No.36, Mid Dongfeng Road, Jinshui District, Zhengzhou, Henan Province, China

Zip Code: 450053    Telefax: +86 371 63295101 ,63295102

E-mail: xmd@jayopetro.com    xmd371@yahoo.com.cn

Http://www.jayopetro.com



## ◆ High-flow Pump

It is used for tank truck, tanker, service stations and filling area. It can be also used in chemistry sector, mines and other industry sectors.

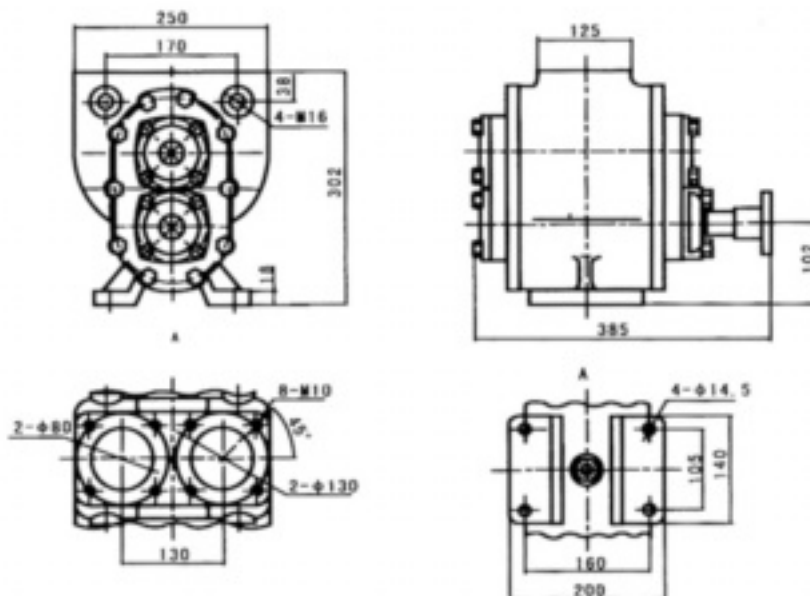

JY-1000/5A

## ◆ Features:

- 1) It is a gear arc oil pump.
- 2) Compact, high-flow, high lift ,low noise and strong self-priming capability.
- 3) Using soft metal as gear-surface to eliminate heat in the gear-surface friction and avoid static convergency, so it is very safe.
- 4) Used to trasfer noncorrosive liquid without solid granule.
- 5) JY-1000/5B is another product different from JY-1000/5A. Comparing with JY-1000/5A, it has effective safety equipment. However, their working principles and installation sizes are same.

## ◆ Technical Data

Name	Parameter
Inlet & outlet diameter	80mm
Max flow	1000L/Min
Max output pressure	0.5Mpa
Rotation speed	700-1250 r/min
Max lift	60m
Permitted suction lift	7m
Motor power	11kw
Medium viscosity	5cP-53cP
Temperature	-30°C –80°C



JYC-1000/5M

Add: No.36, Mid Dongfeng Road, Jinshui District, Zhengzhou, Henan Province, China

Zip Code: 450053   Telefax: +86 371 63295101 ,63295102

E-mail: xmd@jayopetro.com   xmd371@yahoo.com.cn

Http://www.jayopetro.com



## ◆ YB Series Rotary Vane Pump



YB Series self priming rotary vane pump with internal by-pass valve . The pumps use a rotor with sliding vanes to draw the liquid. The material of construction is nodular iron with sliding vanes built in a special self lubricat-ing material. Due to its efficiency the pumps can handle viscous and also volatile liquids and require less horsepower than other equivalent pumps.The pumps are capable of higher flow-rates at lower number of revolutions than other designs.

## ◆ Application Range

- ◇ Fuel oil delivery truck
- ◇ Lube oil
- ◇ Fleet refueling
- ◇ Aviation refuelers
- ◇ Transport of petrochemicals, gasoline, biofuels, solvents and many more.

## ◆ Installation

The pumps are widely used in mobile applications or fixed installations. With cardan shafts or hydraulic motor the pumps can be installed on any kind of tank truck or they are coupled to electric or diesel engine on metal bases to be used either on terminals, heavy duty dispensers, pumping metering skids.Mobile transfer units . Equipped with Teflon seals the pumps can also be used on a wide variety of solvents in the petrochemical industry.

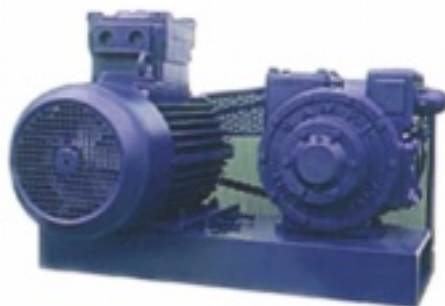

YB-V  
(V-Belt drive)



YB-C  
(Coupling drive)

Add: No.36, Mid Dongfeng Road, Jinshui District, Zhengzhou, Henan Province, China

Zip Code: 450053    Telefax: +86 371 63295101 , 63295102

E-mail: xmd@jayopetro.com    xmd371@yahoo.com.cn

Http://www.jayopetro.com





## ◆ Product: HPB Series of Ex sliding-vane pump

Sliding vane is installed in the slotted rotor, rotor turns centrifugally in the pump body. While rotor is running, sliding-vane slides out of rotor, and then moves close to the inner surface of pump body. According to the rotor's turning, the cavity composed of rotor, sliding-vane and pump body changes its space periodically-----inhaling medium when cavity increases and discharging medium when it decreases. This periodical process goes on until the medium delivery is finished.

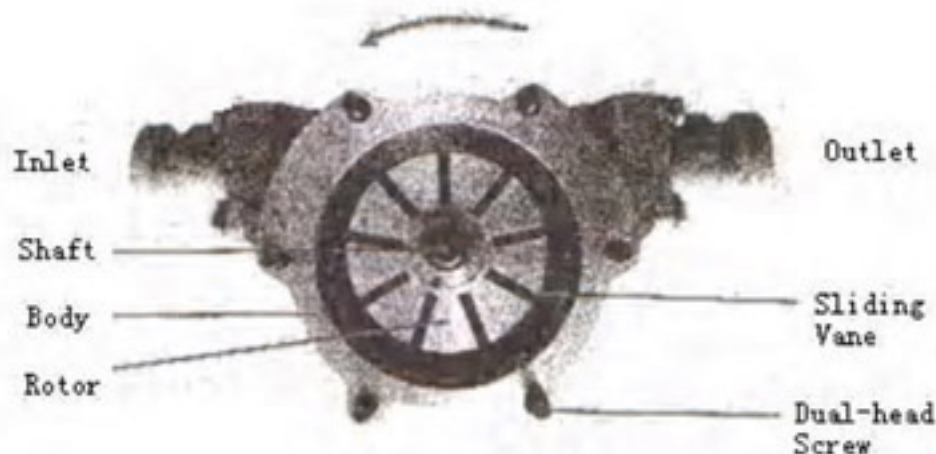

Models	Main parameter				Motor		
	Flux (M <sup>3</sup> )	Pump lift (M)	Suction lift (M)	Diameter (MM)	Frame number	Voltage	Power (KW)
25HPB-5	5	20	5	25	YB <sub>2</sub> 90S-4	380V	0.75
38HPB-10	10	22	6	38	YB <sub>2</sub> 90S-4	380V	1.1
50HPB-18	18	22	6	50	YB <sub>2</sub> 90L-4	380V	1.5
80HPB-35	35	25	6	80	YB <sub>2</sub> 112M-4	380V	4

## ◆ Spare parts

Description	Specification				Quantity	Installation Place
	38MM	50MM	80MM			
Inlet filter	42	54	80	1	Inlet joint	
Framework seal	25*40*10	25*40*10	30*50*10	2	Motor shaft of rear cover	
O-ring seal	150*3.1	150*3.1	195*5.3	2	Cover of the front and rear ends.	
O-ring seal	50*3.1	60*3.1	88*4.1	2	Joints of inlet and outlet.	

Add:No. 36, Mid Dongfeng Road, Jinshui District, Zhengzhou, Henan Province. China

Zip Code:450053 Telefax:+86 371 63295101, 63295102

E-mail:xmd@jayopetro.com xmd371@yahoo.com.cn

Http://www.jayopetro.com



## ◆ Product: AHCB Series of Vane Suction pump

AHCB series pump belongs to inside sealed slip blade self-priming pump. Compared with other pumps, the advantage of this pump is that it can pump and deliver oil automatically without pure oil into the pump. This pump is oil-resistance, general impurity-proof and air-proof. It is high efficiency, fuel-saving in sweeping the remained oil at the bottom of oil tank or trucks.

Besides the features above, the pump also has the notable feature as follows:

1. high vacuum, more 25% than other pumps
2. high efficiency of axis
3. long life, few easy-broken spare parts, easy maintenance
4. compact structure, convenient to use.

This pump can pump and deliver gasoline, Kerosene, diesel, LPG with viscosity below 200 cst. It mainly used to pump, clean up oil tank, load, clean cabin in oil depots, filling stations, car team, etc.



## ◆ Technical data

Model	Flow Range (m <sup>3</sup> /h)	Head (m)	Suction (m)	Self-priming time (s) 5m height	Anti-proof motor (V)	Speed Rate (r/min)	Power (Kw)
AHCB-2-75	4.5	30	9	30	380, 220	1390, 1430	0.75
AHCB-2-400	25	20	9	30	380, 220	1410, 1400	2.2
AHCB-2-650	40	15	9	30	380	1435	4

Add:No. 36, Mid Dongfeng Road, Jinshui District, Zhengzhou, Henan Province. China

Zip Code:450053 Telefax:+86 371 63295101, 63295102

E-mail:xmd@jayopetro.com xmd371@yahoo.com.cn

Http://www.jayopetro.com



◆ **Product: Hand Rotary Pump**

**ORIENT-3 Type**

Suitable for transferring and dispensing gasoline, lubricant and other non-corrosive liquid  
Application: oil drum, tank

- Manual Operation: rotary action
- Maximum flow: 7.5 gallons/100 revolutions
- Inlet tube:
  - ID: 1.1 L1 1/4-inch (32mm)
  - 40-inch (1,015mm) rigid riser tube to suit 36-inch (914-inch) deep drums
  - Blackening
- Outlet tube:
  - ID: one-inch (25mm)
  - Painting or plastic spraying
  - Delivery tube available as optional
- Barrel adapter: 2" BSP aluminum barrel adapter
- Wetted materials: aluminum construction, steel tube
- Appearance: painting or plastic spraying
- Weight: 3.3kg



**ORIENT-101 Type**



- Design: lever action
- Body material: steel
- Wetted part material: steel
- Flow range: stroke cycle, up to 0.5L/stroke
- Fitting size: inlet 1 inch, outlet 3/4 inch
- Fitting type: NPT, buttress thread
- Tank adapter: 2 inch NPT
- Adjustable suction pipe: 19 - 35 inches, 480 - 890mm
- Suit 200/220 liter containers
- Weight: 2.0kg

Add: No. 36, Mid Dongfeng Road, Jinshui District, Zhengzhou, Henan Province, China

Zip Code: 450053 Telefax: +86 371 63295101, 63295102

E-mail: xmd@jayopetro.com xmd371@yahoo.com.cn

Http://www.jayopetro.com



## ◆Yg80 Filter

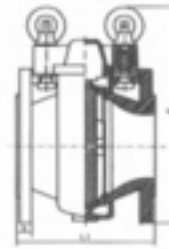

Material	Medium	Nominal Pressure	Ambient Temperature
Aluminum Alloy	gasoline,diesel, kerosene	0.2Mpa	-45°C - +55°C

Size	L	D	D1	D2	Z-d	H	b
2	153	140	110	80	4-14	245	14
3	163	188	150	125	4-18	270	15

## ◆T- Filter

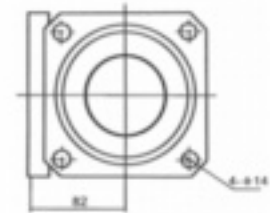
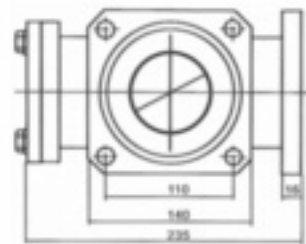

Material	Medium	Nominal Pressure	Ambient Temperature
Aluminum Alloy	gasoline,diesel, kerosene	0.2Mpa	-45°C - +55°C

## ◆Filter for fuel dispensers

We are specialized in supplying all kinds of filters for fuel dispensers, which match with Gilbarco, Bennett, Wayne, Tokheim, NP, SB, Censtar and so on.



## ◆Technical Data

- ◇ Precision :Coarse filtration 80-100 μ m; precise filtration 10-60 μ m
- ◇ Medium : Gasoline, kerosene, diesel and so on.
- ◇ Temperature : -40°C -+70°C

Add: No.36, Mid Dongfeng Road, Jinshui District, Zhengzhou, Henan Province, China

Zip Code: 450053   Telefax: +86 371 63295101 ,63295102

E-mail: xmd@jayopetro.com   xmd371@yahoo.com.cn

Http://www.jayopetro.com



## ◆ The Air-eliminate Filter

It is one of the auxiliaries of a flow meter, being able to separate gas and foreign substances from liquid medium in tube and ensure the measuring accuracy.



LPGX type

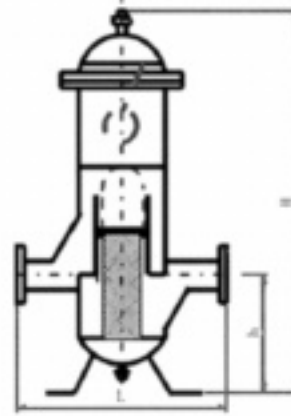

Construction

## ◆ Operational principle

After the product oil flows in, the filter screen in the tube will remove solid impurity. And when the liquid goes through the filter screen, the direction of flow is changed and the free gas and partial dissolved gas will go out, rising to the top of the separator forming a gas space and an oil gas interface. As the gas increases, the pressure and volume both increase, bringing the interface down, until to a certain degree, the ball float device works to open the valve to let gas out. Then the oil-gas interface climbs and the valve is closed again via the ball float device. In this way, the medium can achieve a separation of oil, gas and solid.

## ◆ Other Filters



U Type Filter

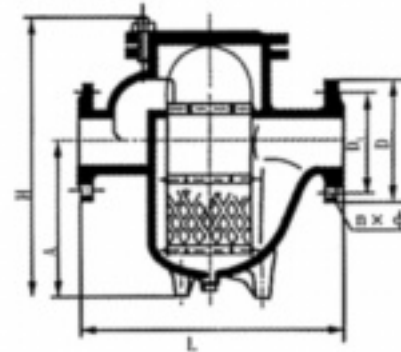

Construction



Y Type Filter

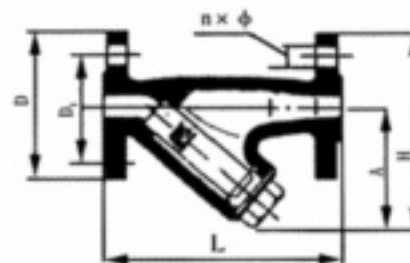

Construction

Add: No.36, Mid Dongfeng Road, Jinshui District, Zhengzhou, Henan Province, China

Zip Code: 450053    Telefax: +86 371 63295101, 63295102

E-mail: xmd@jayopetro.com    xmd371@yahoo.com.cn

Http://www.jayopetro.com



## ◆ Manhole Cover with Oil Gas Reclaiming Valve



Length of circle(mm): 560 / 580  
Hole pitch and hole numbers: 530x24x10 / 540x24x10  
Material: Al.alloy  
Working Pressure (mpa): 0.6

## ◆ Submarine Valve



Specification: 4"  
Hole pitch of round flange: 190x8x14 / 150x8x14  
Material: Al.alloy  
Working Pressure(mpa): 0.6

## ◆ Hose Nipple of Unloading Valve



Specification: 4"  
Ventage Junction: 3" / 2.5"  
Material: Al.alloy  
Working Pressure(mpa): 0.6

## ◆ JAYO-01 API Bottom Loading Adaptor



Body: Al.alloy                      CAM: Aluminum bronze  
Handle: Bronze                      Seals: Fluorocarbon&Buna-N  
API adaptor end: Hard-coated aluminum  
Poppet & Shaft and Latch plate: Stainless steel  
Standard: Meet TTMA Standard

## ◆ JAYO LJQ-01 Tight-Seal Adaptor and JAYO-01 Tight Seal Fill Cap



Elbow Size: 4"                      Riser Thread: BSP/NPT4"  
Material: Bronze                      Cap&Link: Pa66  
Pins: Stainless steel                      Gasket: Buna-N

## ◆ JAYO-SYWG Series Delivery Elbow



Light weight cast aluminum; Fits all 4" top seal adaptors;  
Protective base shield;With sight glass which allows the  
operator to see whether product is flowing.  
SYWG-504 #                      4"Male cam and groove  
SYWG-604 #                      4"Male NPT thread  
SYWG-704 #                      4"Male BSPT thread

## ◆ JAYO-01 5GL Thread-On Spill Container



Cover & Mounting Ring : Cast Iron  
Bellows: Polyethylene                      Base: Compoud Fibre  
Clamps: Stainless Steel                      Seals: Buna-N



## ◆ Product: Static grounding alarms

They are used in service station, LPG station and other places where the tank lorry loads and unloads.

### ◆ Parameters:

1. Explosion proof class: Exia II CT6
2. Detection resistance:  $< 60\Omega$
3. Alarm volume:  $>90\text{Db}$ .
4. Temperature range:  $-40^{\circ}\text{C}-60^{\circ}\text{C}$ .



**JY- F (Fixed)**



**JY-M (Movable)**

### ◆ Advantages:

1. While conducting static, it also detects whether the resistance exceeds standard. When the resistance is over  $60\Omega$  or there is open circuit, it will alarm by sound.
2. The circuit is sealed by epoxy resin, which realize moisture proof, antirust and maintenance-free.
3. Power supply is not needed and battery replacement is unnecessary during normal operation within 5 years.



**JY-L (With alarm)**



**JY-R (Without alarm)**

### ◆ Advantages:

1. Taking restitution force of the spiral-spring as the mechanical motive force, together with the patented non-contact speed limiting device, it makes sure the automatic and uniform speed retracting. The stainless steel wire can be retracted with uniform speed to avoid accident caused by high speed.
2. The static grounding clamp can be located at any place.
3. It can be mounted on the tank lorry.



## ◆ Product: JY-IIB Oil-spill Static Protector

It has the function of static conducting and overfill prevention and is to be used in the loading system of liquid chemical products. It can be interlocked with automatic control system, when the liquid level reaches the sensor or there is ineffective grounding, it will send out acousto-optic alarm and output signal to stop the valve and pump to prevent overfill and ensure static grounding.



## ◆ Advantages:

1. Output signal and interlock with computer system.
2. The sensor has self-checking function. It gives malfunction alarm when it is at fault.
3. Provide on-site acousto-optic alarm, clear and visible.

## ◆ Parameters:

- |   |                            |
|---|----------------------------|
| 1. Explosion proof class: Exdia II BT4                  | 2. Power: 220VAC±10%       |
| 3. Output signal: 1.0A, 24VDC or 0.5A, 125VAC           |                            |
| 4. Optional output signal: 5.0A, 30VDC or 5.0A, 250VAC. |                            |
| 5. Working current: 15mA                                | 6. Response time: < 2s     |
| 7. Detection resistance: < 60Ω                          | 8. Temperature: -40°C-60°C |

## ◆ Product: JY-SA Static Grounding Controller

It can connect computer. When resistance detected is over 60Ω, it will alarm by sound and light and send out standard switch signal, which makes the third equipment disconnect automatically the control system to ensure reliable static grounding.

## ◆ Advantages:

1. Send out standard signal to computer to realize serial control.
2. Supply sound and light alarm on site.
3. Rain protection and antirust.

## ◆ Parameters:

1. Explosion proof class: Exdia II BT4
2. Power: 24VDC
3. Detection resistance: < 60Ω
4. Output signal: 5A, 220VAC or 5A, 30VDC







◆ **Product: JY-IV Oil-spill static protector (used for bottom loading)**

It is suitable for the bottom loading system for liquid chemical products. It monitors the liquid level as well as the static grounding and has the function of static discharging and overfill prevention.

◆ **Advantages:**

1. Measure up API international standard.
2. Static conducting and overfill prevention controller are independent to each other, which makes a clear alarm indication.
3. Humanized design of grounding bolt makes it comfortable to handle.
4. Bracket is provided which makes installation simple.

◆ **Parameters:**

1. Explosion proof class: Exdia II BT4
2. Power: 220VAC $\pm$ 10%
3. Output signal: 8A, 30VDC or 8A, 250VAC
4. Working current: < 45mA
5. Response time: < 2s
6. Detection resistance: < 60 $\Omega$

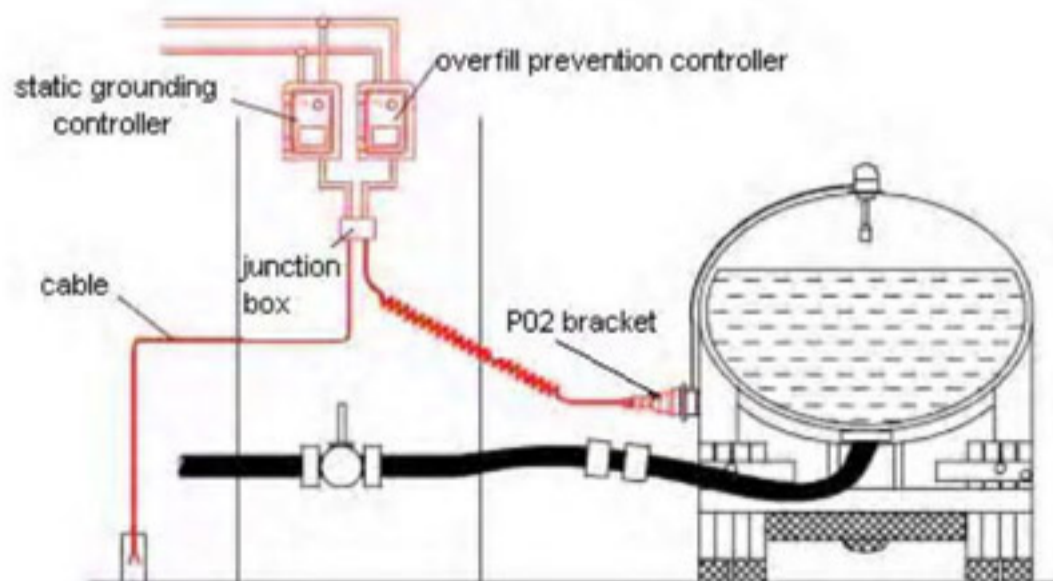
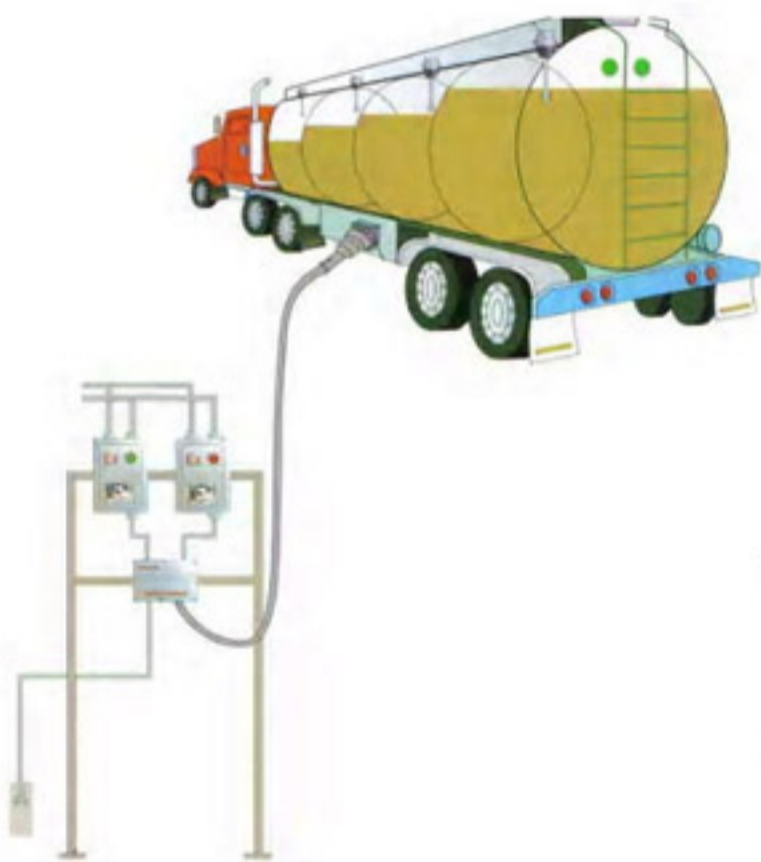



## ◆ Ball Valve



Square Straight Ball Valve

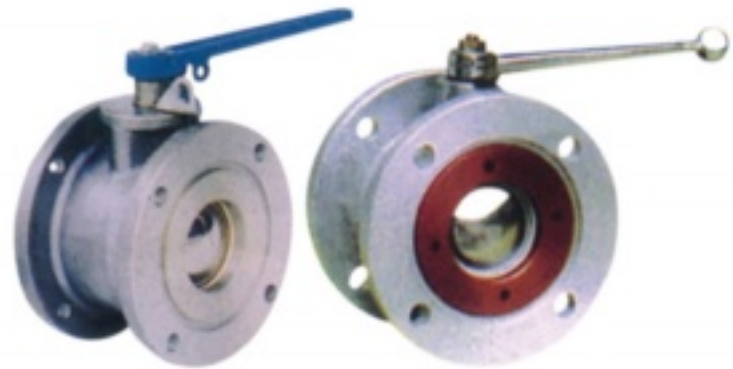

Round Straight Ball Valve

## ◆ Specifications of Straight Ball Valve

Nominal Diameter(mm)	Total Length (square) (mm)	Total Length (round) (mm)	Central Distance (square)(mm)	Central Distance (round)(mm)
40		85		110
50	90	90	130	125
65	122	115	155	150
80	137	135	175	160
100	154		195	



Three Way Ball Valve



Single Phase Ball Valve

## ◆ Ordering Specifications:

Three Way Ball Valve			Single Phase Ball Valve		
Nominal Diameter (mm)	Total Length (square)(mm)	Central Distance (square)(mm)	Nominal Diameter (mm)	Total Length (square)(mm)	Central Distance (round)(mm)
50	150	130	50	140	125
65	200	155	65	160	145
65	220	155	80	180	160
80	220	175			

Add: No.36, Mid Dongfeng Road, Jinshui District, Zhengzhou, Henan Province, China

Zip Code: 450053    Telefax: +86 371 63295101 ,63295102

E-mail: xmd@jayopetro.com    xmd371@yahoo.com.cn

Http://www.jayopetro.com



## ◆ Quick Couplings



Material: Aluminum alloy,  
Stainless steel,  
Working Pressure: 1.2 MPa (Al alloy)  
2.0 MPa (S.S)  
Types: A, B, C, D, E, F, DP, DC, DF, ER, E-A  
E-D, E-E, E-C, Dual Male / Female End

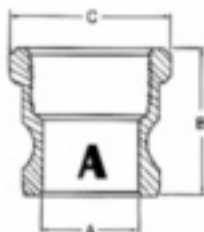

**TYPE A**  
Specification: 3/4"-6"

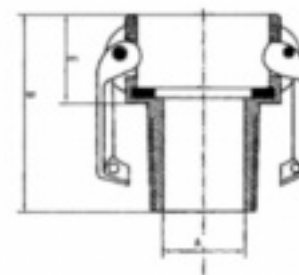

**TYPE B**  
Specification: 3/4"-6"

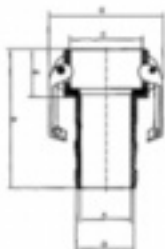

**TYPE C**  
Specification: 3/4"-8"

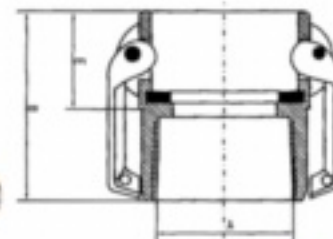

**TYPE D**  
Specification: 3/4"-6"

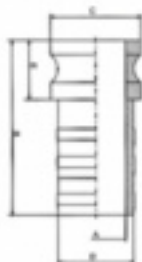

**TYPE E**  
Specification: 3/4"-8"

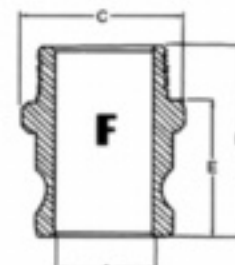

**TYPE F**  
Specification: 3/4"-6"

Add: No.36, Mid Dongfeng Road, Jinshui District, Zhengzhou, Henan Province, China  
 Zip Code: 450053   Telefax: +86 371 63295101, 63295102  
 E-mail: xmd@jayopetro.com   xmd371@yahoo.com.cn  
[Http://www.jayopetro.com](http://www.jayopetro.com)



## ◆ Quick Couplings

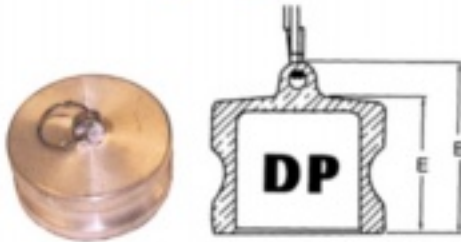

TYPE DP  
Specification: 3/4"-6"

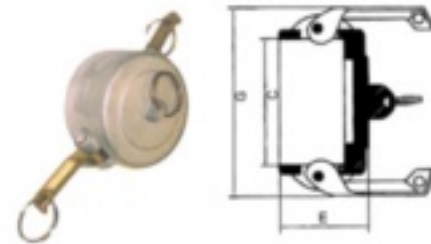

TYPE DC  
Specification: 3/4"-6"



TYPE E-A  
Specification: 3"



TYPE E-E  
Specification: 3"



TYPE E-D  
Specification: 3"



TYPE E-C  
Specification: 3"



Dual male end  
Specification: 2"-4"



TYPE DF  
Specification: 3/4"-6"



Dual female end  
Specification: 2"-4"



TYPE ER  
Specification: 1/2"-3"

Add: No.36, Mid Dongfeng Road, Jinshui District, Zhengzhou, Henan Province, China

Zip Code: 450053    Telefax: +86 371 63295101 , 63295102

E-mail: xmd@jayopetro.com    xmd371@yahoo.com.cn

Http://www.jayopetro.com



## ◆ Submersible Pump



JAYO-240L



JAYO-240H

## ◆ Technical Specification

◇ Rating Pressure:	0.1Mpa
◇ Max Flow Rate:	200L/min, 240L/min
◇ Revolution:	2820 rpm
◇ Voltage:	220V , 50Hz
◇ Current:	9A
◇ Power:	1.1Kw/1.5H, 1.3Kw/1.8H
◇ Ex-proof Class:	1PX 6
◇ Fixation Thread:	BSPT4"
◇ Inlet:	BSPT1.5"
◇ Outlet:	BSPT2"
◇ Adjustable Pressure:	21Kpa-207Kpa
◇ Factory Pressure Range:	79Kpa-93Kpa
◇ Working Pressure:	> 34Kpa
◇ Package:	1pc/2carton
◇ Net Weight:	40kgs
◇ Gross Weight:	45kgs
◇ Dimension:	360x280x370mm /730x170x170mm

## ◆ Benefits & Features

- ◇ Best performance , long time service , lower noise .
- ◇ Easy to install and service, quick , simple and safe electrical connections.
- ◇ Manifold allows for vertical or horizontal discharge.
- ◇ Save time, lower service costs.
- ◇ Built with check valve, by pass valve and vacuum valve.
- ◇ For diesel , gasoline , kerosene , etc . vapour-free , suction head longer than suction pump.

Add: No.36, Mid Dongfeng Road, Jinshui District, Zhengzhou, Henan Province, China

Zip Code: 450053    Telefax: +86 371 63295101 ,63295102

E-mail: xmd@jayopetro.com    xmd371@yahoo.com.cn

Http://www.jayopetro.com



### ◆PVC Hose

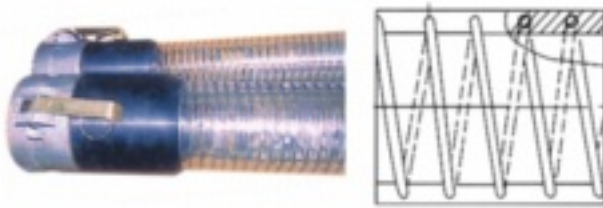

Features& Benefits: Made of PVC and steel wire-spring, flexible, transparent, durable, light weight, easy bending, anti-static, oil-resistance, acid and alkali resistance, and weather resistance.

Inner Diameter (inch)	Weight (Kg/m)	Thickness (mm)	Break Strength (mm)	Working Pressure (Mpa)	Temperature	Per roll Length (m)
1.0	0.5	4.0	156	2.0	-45°C ~ 60°C	50
1.5	0.8	4.0	182	2.0		50
2.0	1.2	5.0	235	2.0		30
2.5	1.8	5.5	290	2.0		20
3.0	2.0	6.0	340	2.0		20
4.0	3.0	6.0	450	2.0		20

### ◆Double-deck PVC Hose



Features & Benefits: Made of PVC and steel wire-spring, with the reinforced layer, flexible, transparent, durable light weight, easy bending, anti-static, oil- resistance, acid and alkali-resistance, weather-resistance.

Inner Diameter (inch)	Thickness (mm)	Working Pressure (Mpa)	Temperature
0.6	4.0	3.0	-45°C ~ 60°C
1.0	4.5	3.0	
1.2	4.5	3.0	
1.5	5.0	3.0	
2.0	5.0	3.0	
2.5	5.5	3.0	
3.0	6.0	3.0	

### ◆Rubber Hose for Dispenser



The hose can eliminate the static accumulation while oil-delivering and meet the requirements of fire safety.

Inner Diameter (mm)	Outer Diameter (mm)	Working Pressure (Mpa)	Bursting pressure (Mpa)	Per Roll Length (m)
19	30	0.8	3.2	20
25	37	0.8	3.2	20

Add: No.36, Mid Dongfeng Road, Jinshui District, Zhengzhou, Henan Province, China

Zip Code: 450053    Telefax: +86 371 63295101 ,63295102

E-mail: xmd@jayopetro.com    xmd371@yahoo.com.cn

Http://www.jayopetro.com



### ◆ Corrugated pipe

- ◇ Size: DN25mm-100mm
- ◇ Material: Stainless steel
- ◇ Working pressure: 0.6-1.0Mpa

### ◆ Application Range

- ◇ Applied to transport steam, water, oil, gas and chemicals
- ◇ Used to redeem eccentricity of the pipes' installation
- ◇ Help the connected pipes' reciprocation
- ◇ Used to absorb vibration
- ◇ Working environment: Temperature: -196 to 800°C  
Max. Pressure: 21MPa
- ◇ Connection method: thread fittings, flange, pipe connect, quick coupling

### ◆ Typical application:

- ◇ Metallurgy industry, alchemy, and hot rolling mills
- ◇ Oil refining, oil gas storage and transport
- ◇ Nuclear industry
- ◇ Shipbuilding industry
- ◇ Specifications: DN6 to DN800mm
- ◇ Length: meet your requirements

### ◆ Construction

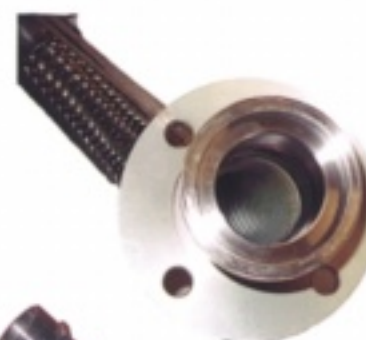
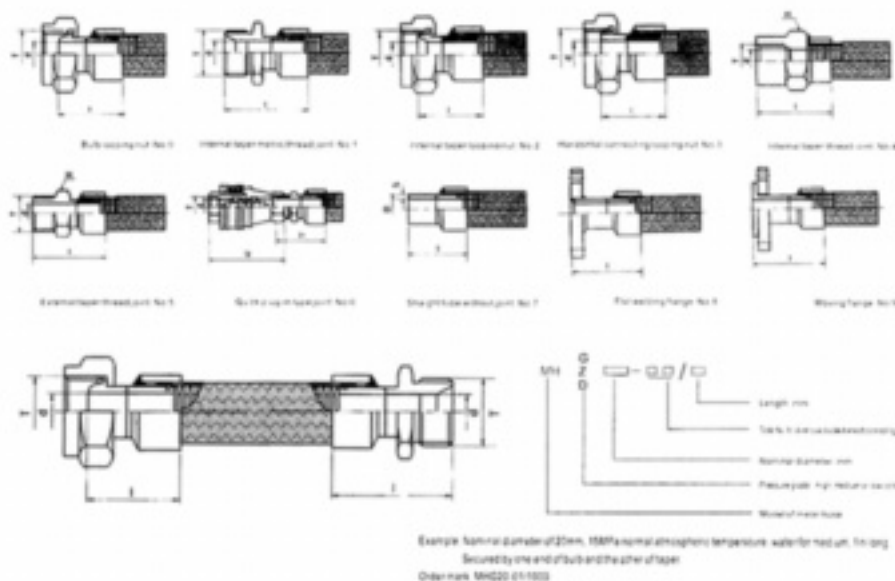



## ◆ETP-60 Electric Transfer Pump Ass



### ◆Features & Benefits

- ◇ It is easy to connect to the 1" quick coupling of the drum or tank, with or without JY-120 flow meter.
- ◇ Standard equipment: self-priming pump, meter, 1" quick coupling, 4meter delivery hose, manual nozzle, intake pipe. Automatic nozzle and other accessories are available on request.

### ◆Technical Specification

Medium: Diesel, kerosene	Flow Rate: 20L/min-60L/min
Power Supply: 220V/50Hz, 0.375KW/2.5A	Condensator: 450V-12.5 μ F
Max. Working Pressure: 3 bar	Motor Rotate Speed: 2800rpm
Accuracy: ± 1% of flow range after calibration	
Digital: 4-digit subtotals (max999.9liters), 8-digit totals	

## ◆JY-120 Flow Meter



- ◇ JY-120 Flow Meter is to measure the exact quantity of the dispensed fuel. They are designed for non-commercial use only. These flow meters are reliable, inexpensive, easy to install and simple to calibrate on the workplace.
- ◇ Aluminium metering chamber, 1"thread connection.
- ◇ Mechanical readout device with rotating wheels.
- ◇ Subtotals can be set to zero, total readouts cannot.

## ◆JY-60 Electric Transfer Pump



- ◇ JY-60 self-priming rotary vane pumps feature a mechanical seal that guarantees constant reliability, even in low temperatures.
- ◇ Cast-iron pump casing, treated against corrosion and paint-finished. Continuous running.
- ◇ Vane pump with steel rotor, mechanical seal.
- ◇ Bypass valve built into pump casing.
- ◇ In-built100-micron filter, easily accessible for cleaning.
- ◇ Induction motor with aluminum casing.
- ◇ Grade of protection: IP 55.
- ◇ 1" Threaded joints on pump casing.

Add: No.36, Mid Dongfeng Road, Jinshui District, Zhengzhou, Henan Province, China

Zip Code: 450053    Telefax: +86 371 63295101 ,63295102

E-mail: xmd@jayopetro.com    xmd371@yahoo.com.cn

Http://www.jayopetro.com





## ◆ Measuring can (Standard metal measuring instruments of capacity)



JY-C



JY-CH



JY-CLS



JY-CLC

## ◆ Specifications

Type	Model	Specification		Accuracy		Material
		II Grade	III Grade	II Grade	III Grade	
Straight Type	JY-C	10,20L	10,20L	$2.5 \times 10^{-4}$	$0.5 \times 10^{-3}$	Stainless Steel
	JY-CH	10,20L	10,20L	$2.5 \times 10^{-4}$	$0.5 \times 10^{-3}$	
Tri-foot and Down Outlet Type	JY-CLS	5,10,20,50,100,200,500,1000L	5,10,20,50,100,200,500,1000L	$2.5 \times 10^{-4}$	$0.5 \times 10^{-3}$	Carbon Steel
	JY-CLC	5,10,20,50,100,200,500,1000L	5,10,20,50,100,200,500,1000L	$2.5 \times 10^{-4}$	$0.5 \times 10^{-3}$	



Depth oil dip gage rod



Oil-finding paste



T-square(measure space height)

Add: No.36, Mid Dongfeng Road, Jinshui District, Zhengzhou, Henan Province, China

Zip Code: 450053    Telefax: +86 371 63295101, 63295102

E-mail: xmd@jayopetro.com    xmd371@yahoo.com.cn

Http://www.jayopetro.com



◆ **High Pressure Washer**



Specifications of JY110  
Motor: Induction-motor  
Pressure: 70bar (1000psi) / 90bar (1000psi)  
Max Pressure: 140bar / 160bar  
Flow: 6.4L/min (1.7GPM) / 6L/min (1.6GPM)  
Power: 1200W / 1300W  
Voltage: 230V/50Hz or 120V/60Hz  
Standard Accessories:washer's gun and flexible hose



Specifications of JY120  
Motor: Induction-motor  
Pressure: 70bar (1000psi)  
          90bar (1300psi)  
          110bar (1600psi)  
Max Pressure: 140bar / 160bar / 200bar  
Flow: 6.4L/min(1.7GPM)  
      6L/min (1.6GPM)  
Power: 1200W / 1300W / 1600W  
Voltage: 230V/50Hz or 120V/60Hz  
Standard Accessories:washer's gun and flexible hose

◆ **Machinery Seals**



Parts: Rotary Face / Stationary Face / Tight Packing  
      Drive Ring / Spring / Spring Seat

Material: SiC/TC/Ceramic/Resin Impregnated carbon  
          (Rotary face & Stationary face)  
          NBR/EPDM/FKM/PTFE(Tight packing)  
          SS304/SS316(Drive ring & Spring & Spring seat)



Pressure in the Seal Chamber: 0-0.8Mpa

Temperature of the Seal Chamber: -20°C -150°C

Revolution: ≤3000r/min

Medium: Oil and minor corrosive liquid

Add: No.36, Mid Dongfeng Road, Jinshui District, Zhengzhou, Henan Province, China

Zip Code: 450053   Telefax: +86 371 63295101 ,63295102

E-mail: xmd@jayopetro.com   xmd371@yahoo.com.cn

Http://www.jayopetro.com



## ◆ Loading Arms

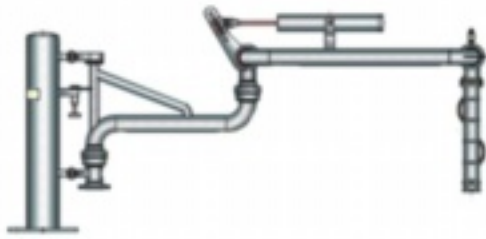

Top Loading Arms( JY-X100)

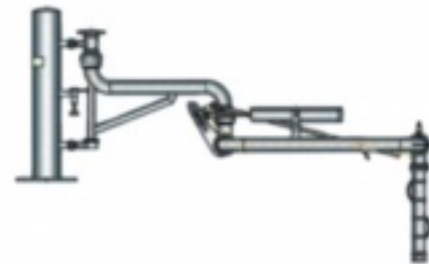

Top Loading Arms( JY-S100)

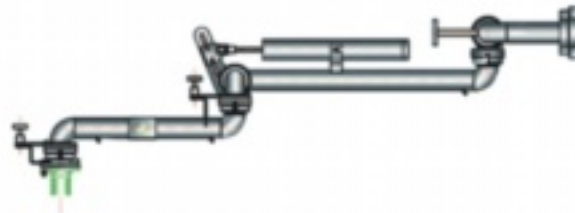

Bottom Loading Arms( JY-P110)

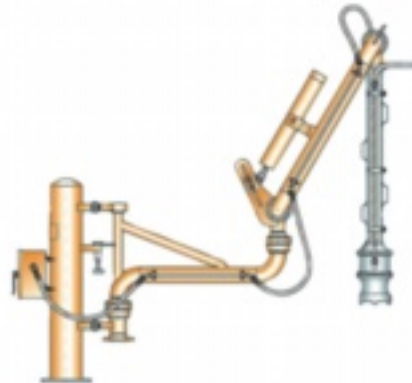

The Pneumatic Operation Style(JY-PSP200)

1. We mainly supply Land Loading Arms. The liquid loading devices manufactured by our company can be perfectly used to transport products under all stringent conditions such as high temperature, low temperature, high pressure and so on.
2. The loading arms are available in size: Land loading arms: DN50-DN150 (2", 3", 4", 6")
3. The land loading arms can be divided into two parts by the loading mode:
  - a) the top loading & unloading arm
  - b) the bottom loading & unloading arm
4. The land loading arms can be operated by:
  - a) manually
  - b) pneumatically

## ◆ Benefits & Features:

1. Easy to operate.
2. Accommodating changes in elevation.
3. Available in steel, stainless steel, aluminum and specialty alloys.
4. Choice of flanged, threaded or all welded construction.

Add: No.36, Mid Dongfeng Road, Jinshui District, Zhengzhou, Henan Province, China

Zip Code: 450053    Telefax: +86 371 63295101, 63295102

E-mail: xmd@jayopetro.com    xmd371@yahoo.com.cn

[Http://www.jayopetro.com](http://www.jayopetro.com)



## ◆ Tank Lorry

Our company exports all kinds of tank lorries for petroleum---gasoline, kerosene, diesel, lube, LPG and so on. The capacity is from 5 cubic meters to 55 cubic meters. According to your requirements, we can design and produce special tanks for you.



## ◆ Technical Data.

Type	JY514GJY7D2		Chassis	EQ1141G7D2(EQ153)	
Weight(kg)	Kerb mass	7000	Outer dimension (mm)	length	8500
	Max total mass	14300		width	2470
				height	3000
Engine parameter	type	EQ6BTA5.9 EQB180-20	Wheelbase(mm)		5000
			Tread (mm)	F	1940
				R	1860
Driving specification	Max.speed (km/h)	85	The suspension length (mm)	Front suspension	1245
	Max. gradient Ability(%)	28		Rear suspension	2255
	Fuel consumption (L)	21.5	Run angle (°)	Approaching angle	14
				Departure angle	12
	Min.turning diameter(m)	18	Min.ground clearance (mm)		248
Tank cubage	Rated cubage(L)	10000	Max cubage(L)		10000-12000
	Flux:60m <sup>3</sup> /h		Work pressure:0.6Mpa		

Add: No.36, Mid Dongfeng Road, Jinshui District, Zhengzhou, Henan Province, China

Zip Code: 450053    Telefax: +86 371 63295101, 63295102

E-mail: xmd@jayopetro.com    xmd371@yahoo.com.cn

Http://www.jayopetro.com



## ◆ Semi-trailers



## ◆ Technical Data

Items		Units	Parameter	
Name			JYHB CL Semi-trailer	
Size compartment		mm	Volume effective 35M3	
Tank size and shape			11000 × 2150 × 1900 (major axis × minor axis × L)	
Body internal dimensions			10850 × 2480 × 3330	
G.V.W		kg	32630	
Payload			22000	
Mass in working order			10630	
wheel base		mm	6270+1310	
tread	front-wheel		-	
	rear-wheel		1840	
Tyre specification		11.00-20	Number of axles	2
Number of tyre		8	Front/Rear axle	-/13T FUHUA
Equipment		<ul style="list-style-type: none"> <li>◆ Material:5mm carbon steel. Flow meter, tankerpiston and bobbin disk can be chosen freely.</li> <li>◆ Tank can be separated to several unattached small tanks to fill different fuels.</li> </ul>		
Production cycle		18~20days		
Warranty		12month from the date of supply		

Add: No.36, Mid Dongfeng Road, Jinshui District, Zhengzhou, Henan Province, China

Zip Code: 450053    Telefax: +86 371 63295101 ,63295102

E-mail: xmd@jayopetro.com    xmd371@yahoo.com.cn

Http://www.jayopetro.com



## ◆ Automatic Tire Inflator

Automatic tire inflator series is Hi-tech product on the basis of advanced automatic control technology. The machine adopts oil-free compressor and supports three measuring units: Kpa, bar and psi. Moreover, customers can have options of some accessories, such as air compressor, hose and so on.

Compared with common artificial inflating, it not only enhances working efficiency, but also makes sure tire pressure veracity. In recent years, more and more tire inflators appear in fuel stations, hotels, service stations, etc. They improve customers' images and service efficiency.



## ◆ Functions:

- ◇inflating, deflating
- ◇testing tire pressure
- ◇injecting water

## ◆ Features:

- ◇Inflate, deflate, test tire pressure automatically
- ◇Accurate tire pressure test , extending tire life
- ◇Low noise, environmental protection
- ◇Improve security and comfort of vehicle
- ◇Reduce fuel consumption and vehicle shock
- ◇Reduce tire noise and tire abrasion
- ◇Durable, high return on investment

## ◆ Working Flow:



## ◆ Applications:

Service station , Bus corporation , Transport company , Fuel station ,Hotel



## ◆ JY660(Luxury)



### ◆ Features:

- ◇ Mix inflating, deflating, testing tire pressure and injecting water in one
- ◇ Oil-free air compressor
- ◇ Water and dust-proof Al-alloy shell
- ◇ Fast, safe, accurate and easy to operate
- ◇ High-grade coat for superior protection
- ◇ Induction metal key with long lifetime
- ◇ Optional telescopic gas heave, water heave
- ◇ Can be used in extreme environment ( $-40^{\circ}\text{C}$  - $80^{\circ}\text{C}$ ) by adopting auto-heater
- ◇ Suitable for engineering vans, trucks and cars

## ◆ JY620-A(Luxury)



### ◆ Features:

- ◇ Inflating, deflating and testing tire pressure automatically (function of injecting water for option)
- ◇ High strength Alloy shell
- ◇ Industrial components for extreme environment
- ◇ Triple filters (filter air, water, oil)
- ◇ Fast, safe, accurate and easy to operate
- ◇ Real-time display of tire pressure
- ◇ LCD display (can be operated at night)
- ◇ Explosion-proof
- ◇ Suitable for engineering vans, trucks and cars.

### ◆ Technical Data:

- |  |                                  |
|--|----------------------------------|
| ◇ Enclosure Material: Alloy                            | ◇ Inflation Pressure :800Kpa     |
| ◇ Dimension :1510×320×270mm                            | ◇ Deflation Pressure : 1000Kpa   |
| ◇ Weight :30KG   | ◇ Max. Current: 0.5A             |
| ◇ Voltage: AC220V                                      | ◇ Measuring Accuracy: 0.02bar    |
| ◇ Power Frequency: 50HZ                                | ◇ Measuring Units: Kpa, bar, psi |
| ◇ Max. Air Production: according to the air compressor |                                  |

Add:No. 36, Mid Dongfeng Road, Jinshui District, Zhengzhou, Henan Province. China

Zip Code:450053 Telefax:+86 371 63295101, 63295102

E-mail:xmd@jayopetro.com xmd371@yahoo.com.cn

Http://www.jayopetro.com



## ◆ JY610-A(Luxury)

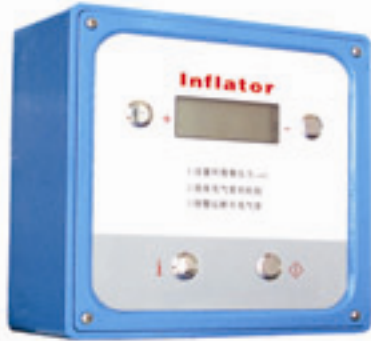

### ◆ Features:

- ◇Inflating, deflating and testing tire pressure
- ◇Water and dust-proof alloy shell
- ◇LCD display
- ◇Industrial components and triple filters (filter air, water and oil) for application in harsh environment
- ◇Fast, safe, accurate and easy to operate
- ◇Inflating and deflating automatically
- ◇Real-time display of tire pressure
- ◇Suitable for engineering vans, trucks and cars
- ◇Used in service station, transport corporation, fuel station and bus corporation

### ◆ Technical Data

- ◇Enclosure Material: Alloy
- ◇Dimension: 260×260×150 mm
- ◇Weight : 4KG
- ◇Voltage :AC220V
- ◇Power Frequency: 50HZ
- ◇Max. Air Production: according to the air compressor
- ◇Power: 100w
- ◇Inflation Pressure: 800Kpa
- ◇Deflation Pressure: 1000Kpa
- ◇Measuring Accuracy: 0.02bar
- ◇Max. Current: 0.5A
- ◇Measuring Units: Kpa, bar, psi

## ◆ JY610(Economy)



### ◆ Features:

- ◇Inflating, deflating and testing tire pressure
- ◇Sheet metal shell
- ◇LCD display
- ◇Fast, safe, accurate and easy to operate
- ◇Inflating and deflating automatically
- ◇Real-time display of tire pressure
- ◇Suitable for trucks and cars
- ◇Used in service station, transport corporation

### ◆ Technical Data

- ◇Enclosure Material: Alloy
- ◇Dimension: 260×260×150 mm
- ◇Weight : 4KG
- ◇Voltage :AC220V
- ◇Power Frequency: 50HZ
- ◇Max. Air Production: according to the air compressor
- ◇Power: 100w
- ◇Inflation Pressure: 600Kpa
- ◇Deflation Pressure: 800Kpa
- ◇Measuring Accuracy: 0.02bar
- ◇Max. Current: 0.5A
- ◇Measuring Units: Kpa, bar, psi

Add:No. 36, Mid Dongfeng Road, Jinshui District, Zhengzhou, Henan Province. China

Zip Code:450053 Telefax:+86 371 63295101, 63295102

E-mail:xmd@jayopetro.com xmd371@yahoo.com.cn

Http://www.jayopetro.com





## ◆ JY620(Economy)



### ◆ Features:

- ◇Inflating, deflating and testing tire pressure
- ◇Alloy shell
- ◇LCD display
- ◇Fast, safe, accurate and easy to operate
- ◇Inflating, deflating automatically
- ◇Real-time display of tire pressure
- ◇Optional water injecting accessories
- ◇Suitable for trucks and cars

### ◆ Technical Data

- ◇Enclosure Material: Alloy
- ◇Dimension: 1510×320×270mm
- ◇Weight: 30KG
- ◇Voltage: AC220V
- ◇Power Frequency: 50HZ
- ◇Max. Air Production: according to the air compressor
- ◇Power: 100w
- ◇Inflation Pressure: 600Kpa
- ◇Deflation Pressure: 800Kpa
- ◇Max. Current: 0.5A
- ◇Measuring Accuracy: 0.02bar
- ◇Measuring Units: Kpa, bar, psi

## ◆ JY1.5 Series



JY1.5-001

### ◆ Features:

- ◇Operate easily, accurate
- ◇Excellent production technology
- ◇Stable property
- ◇One key control
- ◇Engineering plastics Alloy enclosure (pc+abs)
- ◇ Import pressure sensor
- ◇Without air compressor inside. It can match piston air compressor.

### ◆ Technical Data

- ◇Power Supply: AC220V/110V, 50HZ/60HZ
- ◇Input Air Pressure: ≤10bar
- ◇Pressure Output Range: 1.5-9.9 bar
- ◇ Accuracy: ≤0.01bar
- ◇Dimension: 10\*35\*55cm (JY1.5-001)  
35\*35\*120cm (JY1.5-002)
- ◇Packing Size: 58\*48\*20cm (JY1.5-001)  
112\*37\*23cm (JY1.5-002)
- ◇ Gross Weight: 8.5kg (JY1.5-001), 17kg (JY1.5-002)
- ◇ Color: Red or Blue



JY1.5-002



## ◆ Some Accessories



### ◆ Italy air compressor (Optional)

- ◇Voltage: AC220V/50HZ
- ◇Cylinder:1/1
- ◇Max. gas production:6m<sup>3</sup>/h,100L/min
- ◇Max. pressure:8bar
- ◇Output power:0.56kw/ 0.75hp
- ◇Rotation speed:1450RPM
- ◇Weight:11kg



### ◆ Main Board

- ◇Main board I; working temperature:0~60°C
- ◇Main board II; working temperature:-40~80°C



### ◆ Main Board

- ◇Control signal:DC12V
- ◇Output:AC220V,30A



### ◆ Filter

- ◇Filter I : Air filter;
- ◇Filter II: Triple filters for option in harsh environment



### ◆ Hose

- ◇Hose I( pressure: 1.6Mpa)
- ◇Hose II(pressure:22.5Mpa)

## ◆ External air compressor



Model	Power (kw/HP)	Speed (RPM)	Piston (mm)	Volume (m <sup>3</sup> /min)	Pressure (Mpa/Bar)	Tank (L)	Weight (kg)
JY- CA65	0.75/1	850	44	0.08	0.8/8	30	67
JY- VA80	3.0/4	920	60	0.45	0.8/8	80	203
JY- TA100	7.5/10	920	70	1.20	0.8/8	200	441
JY-HTA-65	2.2/3	800	44	0.27	1.25/12.5	70	122



## ◆ Nitrogen inflator



JY-1135

### ◆ Technology Parameter

- ◇ Power Supply: AC 220V/110V, 50HZ/60HZ
- ◇ Nitrogen purity: 95-99.5%
- ◇ Production capability: 3000L/h
- ◇ Outlet Pressure: 8.5bar, Inter pressure: 9.5bar
- ◇ Tank Capacity: 60L (Built-in)
- ◇ Air Extraction/Nitrogen Inflation

### ◆ Portable Air Extraction & Nitrogen inflator

- ◇ Dimension: 62\*43\*126cm
- ◇ Packing Size: 73.5\*51.5\*141 cm
- ◇ Gross Weight: 112kg
- ◇ Usage: Cars, Light-Trucks, Minibuses
- ◇ Color: Red or Blue



JY-1150

### ◆ Technology Parameter

- ◇ Power supply: AC 220V/110V, 50HZ/60HZ
- ◇ Nitrogen purity: 95~99.5%
- ◇ Production capability: 4000L/h
- ◇ Outlet pressure: 8.5 bar, Inlet pressure: 9.5 bar
- ◇ Tank capacity: 130L (Built-in)
- ◇ Air extraction/Nitrogen inflation

### ◆ Portable Air Extraction & Nitrogen inflator

- ◇ Dimension: 74\*50\*140cm
- ◇ Packing size: 83.5\*53.5\*156 cm
- ◇ Gross weight: 160 kg
- ◇ Application: Cars, Light-trucks, Minibuses
- ◇ Color: Red or Blue



JY-1680

### ◆ Technology Parameter

- ◇ Power supply: AC 220V/110V,50HZ/60HZ
- ◇ Nitrogen purity: 95~99.5%
- ◇ Production capability: 10000 ~ 12000 L/h
- ◇ Outlet pressure: 15 bar JY-1680(15 bar)  
10 -13 bar JY-1680(10 bar)
- ◇ Inlet pressure: 9.5 bar JY-1680(15 bar)  
12-15 bar JY-1680(10 bar)
- ◇ Tank capacity: 130L (Built-in)
- ◇ Dimension: 76\*59\*150cm
- ◇ Packing size: 86.5\*68.5\*164 cm
- ◇ Gross weight: 220 kg JY-1680(15 bar)  
200kg JY-1680(10 bar)
- ◇ Application: Cars, Buses, Trucks
- ◇ Color: Red or Blue

Add:No. 36, Mid Dongfeng Road, Jinshui District, Zhengzhou, Henan Province. China

Zip Code:450053 Telefax:+86 371 63295101, 63295102

E-mail:xmd@jayopetro.com xmd371@yahoo.com.cn

Http://www.jayopetro.com



## ◆ LPG dispenser and spare parts

### ◆ LPG dispenser

Voltage : 220V, 50hz  
 Flow range: 13-65L/min  
 Accuracy:  $\pm 0.5\%$   
 Display resolution: 0.01liter  
 Contents: Dispense amount  
 Total dispense: 1-999999liters  
 Dispense amount: 0.01-9999.99 liters  
 Unit price: 0.01-0.99/liter  
 totalize : 1-999.999liters  
 Intensity test: 2.0Mpa  
 Air tightness test : 1.8Mpa  
 Solenoid valve : AC 220V Ex proof  
 Flow rate: 75L/min  
 Safety return valve: 1.6Mpa



### ◆ LPG meter-1



Max Working Pressure : 1.8MPa  
 Flow Rate: 5~60L  
 Discharge rate per revolution : 0.5L/r  
 Adjustable Minimum Volume: 0.1%  
 Accuracy:  $\pm 0.5\%$   
 Repeatability Tolerance :  $\leq 0.25\%$   
 Package: 1pcs/carton  
 Net Weight: 13kg  
 Gross Weight: 14.5kg  
 Dimension: 360×290×360mm

### ◆ Flow meter -2 :

Max Working Pressure: 1.8MPa  
 Flow Rate: 5-60L  
 Discharge rate per revolution: 0.5L/r  
 Adjustable Minimum Volume: 0.1%  
 Accuracy:  $\pm 0.5\%$   
 Repeatability Tolerance:  $\leq 0.25\%$   
 Package: 1pc/carton  
 Net Weight: 31kg  
 Gross Weight: 33kg  
 Dimension: 360×290×360mm





## ◆ LPG Nozzle

Durable construction heavy-duty brass, aluminum and stainless-steel construction provides excellent corrosion resistance in the harsh fueling environment.

Maximum Operating Pressure: 350psi  
LPG Discharge on Disconnect: 4.3cc  
Temperature Range: -40°C ~ 85°C (-40°F ~ 185°F)  
Materials: Body: Aluminum  
Internal Components: Brass/Steel  
External Components: Brass/Stainless Steel



Package: 10 pcs/carton  
Net Weight: 20 Kg  
Gross Weight: 21Kg  
Dimension: 360×320×320 mm

## ◆ LPG Separator

(Check valve, filter, by pass pipe built in LPG separator)

Working Pressure : 2.5MPa  
By Pass Pressure : 4.0MPa  
Strainer : 0.08mm  
Package: 1pcs/carton  
Net Weight: 17.5kg  
Gross Weight: 23kg  
Dimension: 470×300×310mm



## ◆ LPG relief valve

Working Pressure : 2.0MPa  
Package: 36pcs/carton  
Net Weight: 25kg  
Gross Weight: 26kg  
Dimension: 530×250×360mm





### LPG Breakaway valve



Thread: M27×1.5  
Material: Stainless Steel  
Max.Pull: 120Bar  
Flow Rate: 5-50L/min

### LPG Hose



#### A type

A Type Rubber Hose, 1M with coupling



#### B type

B Type Rubber Hose with Stainless Steel Net, 1M with coupling



## ◆ Side Channel Multistage Pump

The JY-65 multistage pump, centrifugal and side channel, is designed with 6 stages, having a horizontal configuration, Shaft sealing by mechanical seal without cooling, for handling LPG (liquid gas), the liquids involving high-differential pressure, low NPSH conditions and aerated liquids up to 50% gas, such as pumping from underground tanks. The use of a pre-compression turbine at the suction end makes it possible to obtain a very small required NPSH, so that this pump can be used under very difficult suction conditions.

### Application :

LPG cylinder filling ;Pumping LPG from underground storage ;Bulk filling operations ;Loading/unloading of bulk trucks and transport trailers;vaporizer feed pumps.

Direction of rotation: anti-clockwise facing the end of the pump drive shaft

Max. Pressure : 40 bars at 120°C

Speed : 1450rpm

Power: 380V,50Hz,4KW

Ambient Temperature: 20°C ~ +60°C

Number of stages : 6

Connecting flanges: DIN 2501, PN 40 as per DIN 2501, PN 40

Bearings : sleeve bearing at the pump end, ball bearing at the drive end

Lubrication: plain bearing at the pump end lubricated by the pumped product, ball bearing at the drive end lubricated for life.



Model: JY-65 w/motor

Package: 1pcs/Wood Case

Net Weight: 136kg

Gross Weight: 160kg

Dimension: 1170×420×450mm

JY-65 without motor

1pcs/Wood Case

64kg

78kg

1000×480×450mm

## ◆ LPG Solenoid Valve:

Precise action, reliable, long service.

Diaphragm of main valve has capability of anti-corrosion and resisting -20°C low temperature.

Special stainless steel magnetic material never rusts and generates remanent magnetism.

Class F loop with good insulation.

Anti-Explosion Class: EXd II B

Diameter: 20mm/"

Connection: Thread

Flow Rate: 5-50L/min

Working Pressure: 0~1.6Mpa

Voltage : AC220V 50Hz

Ambient Temperature: -20°C ~ 65°C

